

■ PRODUCT



HCE150 HCE225

■ DESCRIPTION

- Various installation methods : ceiling/wall/window mounting
- Simple and easy maintenance design
- Installed with silent ball bearing and high quality ABS material
- We care about the aesthetical and functional design of the fan : insects proof, sand proof, dust proof, water spray proof, protecting indoor privacy (*P5*-Protection 5 design)

Damper/shutter

- Shutter equipped with actuator ensures smooth opening/shutting of shutter.
- Alignment of shutter operating angle with the fan cover ensures smooth movement of airflow.
- Efficient/effective protection from dust/sand/outdoor objects/reverse airflow to indoor.

Double louver design

- A . A safety guard against outdoor objects
- B . "P5" -Protection 5 design to satisfy all seasons ventilating needs

Vibration proof cushion sealing

- Vibration proof cushion ensures best sealing for water spray, vibration proof, outdoor dust/sand/objects and protection for the fan unit

Radiator

- Motor heat release device for durable and stable operation
- Vibration proof cushion between motor and fan body to ensure stable and low noise operation

Excellent performance motor

- Equipped with professional ball bearing, enclosed casing and built-in thermal protection.
- Efficient starting, durable, safe and stable operation

Fan blade design

- Aerodynamic shaping blades ensure best ventilating performance and low noise operation <reduce 6dB(A)>



HCE SERIES

■ SPECIFICATIONS

Model	Volt/Hz (V/Hz)	Input Power (W)	Air Volume (m ³ /h)	Speed (r/min)	Sound Level dB(A)	Installation Size (mm)
HCE150	220-50	21	240	1425	44	175
HCE225	220-50	33	630	1220	54	250

■ DIMENSIONS(mm)

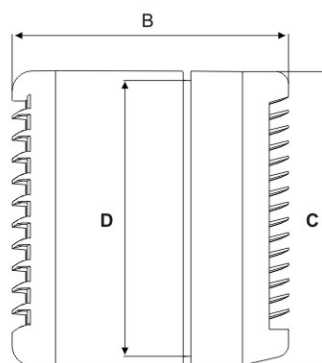
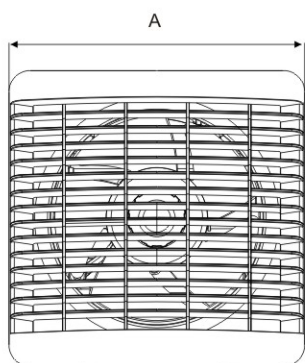

HCE150 HCE225

Model	A	B	C	D
HCE150	230	220	230	Φ183
HCE225	300	196	300	Φ258